

# SLOPES EXHIBIT FOR FOUNDER'S RIDGE

A PORTION OF SECTIONS 22, 26 AND 27, TOWNSHIP 19 NORTH, RANGE 1 EAST, W.M.  
CITY OF DUPONT, PIERCE COUNTY, WASHINGTON

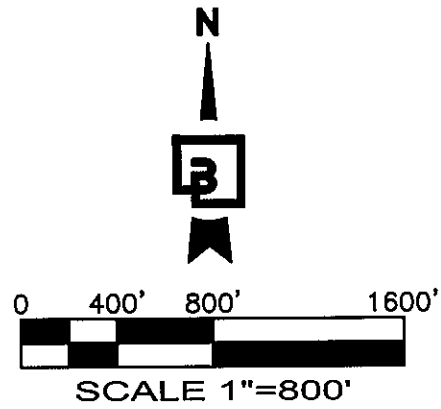
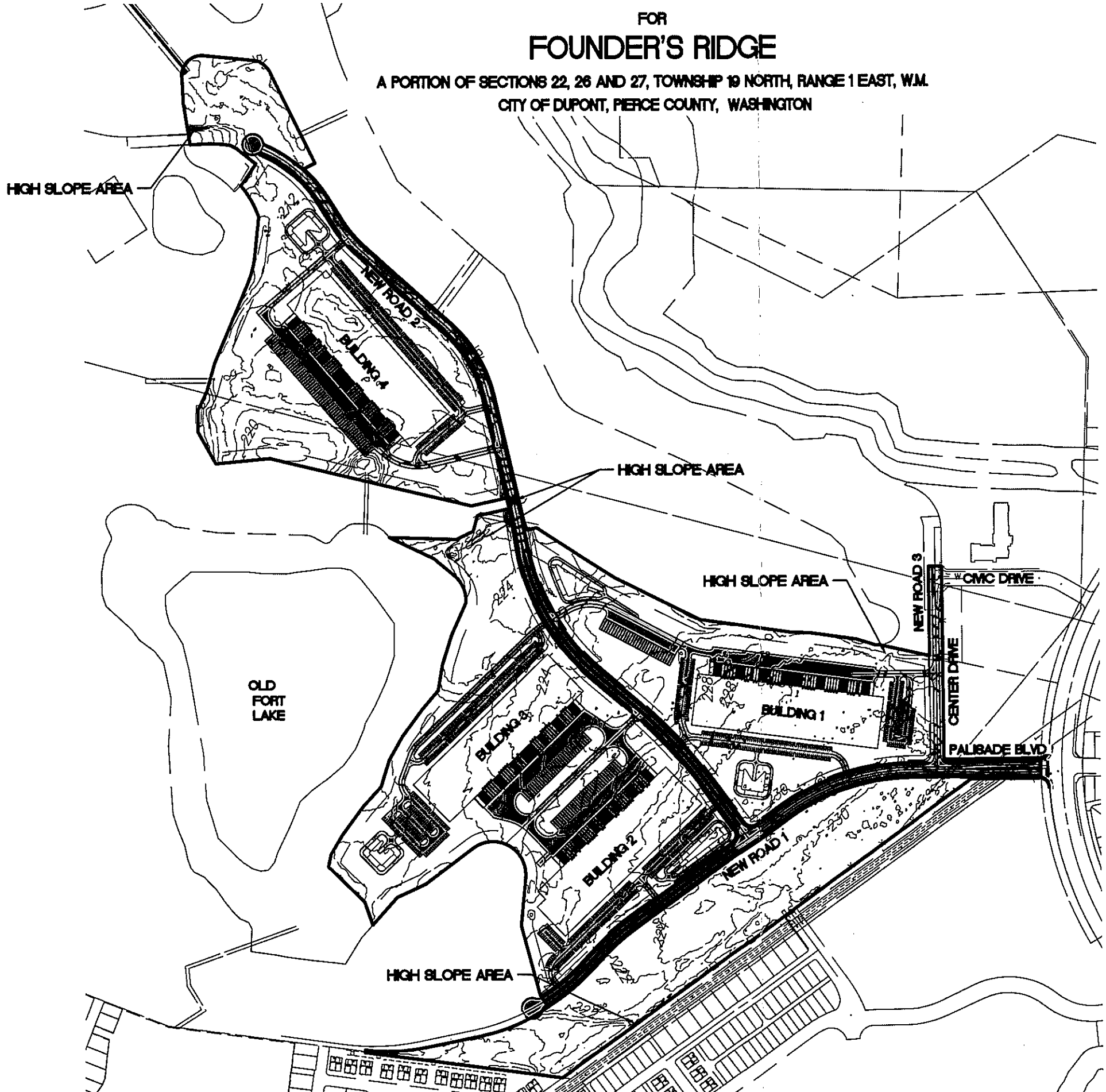

**█** = SLOPES GREATER THAN 40%

RECEIVED  
DEC 23 2021  
CITY OF DUPONT

NOTES:  
SLOPES AND CONTOURS ARE BASED ON 2011 LIDAR INFORMATION AND HAVE NOT BEEN VERIFIED BY BARGHAUSEN.  
CONTOURS ARE BASED ON 2-FOOT INTERVALS  
VERTICAL DATUM: NAVD 88

Revision			
No.	Date	By	Ckd. Appr.
Title: SLOPES EXHIBIT			
For: NORTHPOINT DEVELOPMENT			
Scale:		Horizontal 1"=800'	
Vertical		-	
Designed	SAR	Drawn	SAR
Checked	BHE	Approved	BHE
Date		12/22/21	
Barghausen Consulting Engineers, Inc.		18215 72nd Avenue South Kent, WA 98032 425.251.6222 barghausen.com	
Job Number		21633	
Sheet		1 of 1	